

INSTALLATION INSTRUCTIONS FOR THERMOSTATIC EXTENSION KITS

MODEL # SS-EXT40/ SS-EXT50 (new style)

No.	Part #	Description
1	SS-TFP100 (SS-TFP200)	THERMOSTATIC FACE PLATE
2	THRM-LOCK RNG	THERMO FACE PLATE LOCK RING
3	THRM-INNER SLEEVE	INNER SLEEVE
4	THRM-OUTER SLEEVE	OUTER SLEEVE
5	TEMP LIMIT STOP RING	PLASTIC TEMPERATURE LIMIT STOP RING
6	EXTENSION LIMIT STOP RING	PLASTIC EXTENDED TEMP. LIMIT STOP RING
7	FRICTION RNG	FRICTION RING
8	STEM ADAPTER	STEM ADAPTER
9	STAND OFF STUDS	STAND OFF STUDS
10	SS-TH3000 (SS-TH4000)	THERMOSTATIC VALVE
11	THRM SET SCREW	THERMOSTATIC SET SCREW
12	SS-THD200-___	THERMOSTATIC HANDLE TRIM

1. Remove all decorative trim (1, 2, 3, 4, 5, 6) from valve body (10).
 - a. Note: some models have exposed handle screws (11) and some models have concealed handle screws (11). Once the screw is removed, the handle will PULL off.
 - b. **NOTE: If your trim contains a friction ring (7) or stand off studs (9), you may discard these as the extension kit does not require these parts. The Temp. Limit Stop Ring (5) and THRM-OUTER SLEEVE (4) will also be discarded and replaced with the Extended Temp. Limit Stop Ring (6) and Extended THRM-OUTER SLEEVE, respectively.**



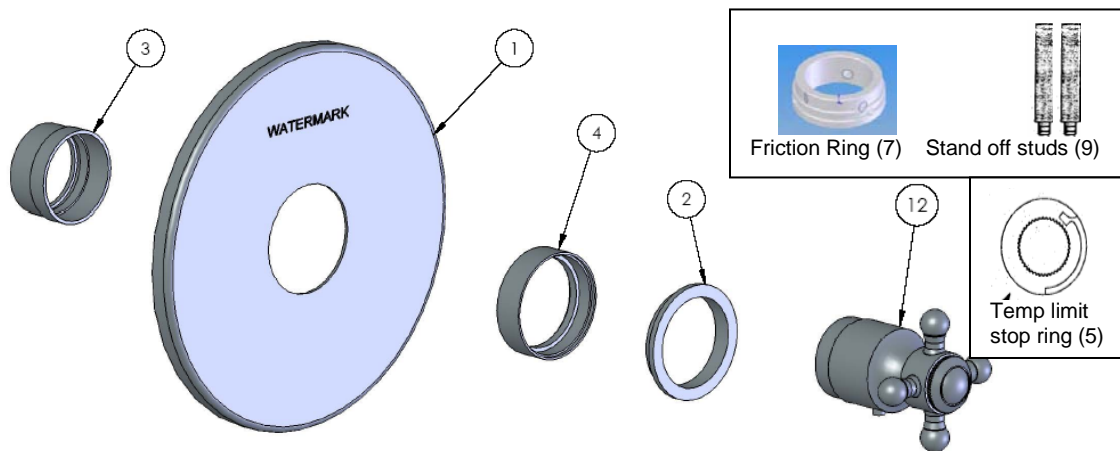

2. Position faceplate (1) on the valve by sliding it over the exposed thermostatic valve stem.
3. Screw inner sleeve (3) of extension kit onto valve body.
 - a. Note: this will be the smaller diameter threads
4. Screw **NEW** outer sleeve (4) into inner sleeve (3). Adjust **NEW** outer sleeve (4) so that its front edge is covered by the faceplate and not exposed.
5. Screw thermostatic lock ring (2) into outer sleeve (4) until it clamps the faceplate onto the wall.
6. Place plastic extended temperature limit stop ring (6) onto valve by pushing it onto the valve stem with the red dot upward at 12:00.
7. Push brass adapter stem (8) through the limiter plastic temperature limiter (6) onto the existing valve stem.
8. **Temperature Setting:**
 - a. Use a thermometer to check the delivered temperature on one of the outlets.
 - b. Adjust water temperature to 100°F by hand turning the valve stem slowly left or right.
 - c. Ensure that the temperature limit stop-ring (6) is installed with red dot at 12 o'clock position.
 - d. Push the handle back on the valve with the push button at the 12 o'clock position.
9. Once the temperature is set, tighten the set screw (11) through the handle (12) into the valve stem so that handle is set in place.
10. **For SS-EXT50 (thermostatic valve with built in volume control)**
 - a. Do the same steps as above for temperature handle
 - b. NOTE: Adaptor stem for volume control does not use the plastic temp. limiter (6).

